

### Safety Information

> All electrical work must be undertaken by a qualified contractor to ensure compliance with latest edition BS 7671 and IEE/IET wiring regulations.

> Before installing an LED Slimline Flood Light or doing any maintenance, ensure power supply is turned off at the circuit breaker or fuse box.

> This product is designed for permanent connection to fixed wiring; the circuit should be protected with the appropriate MCB or fuse.

### Environment

> Please DO NOT dispose of electrical items or packaging as unsorted waste. Use the recycling facilities provided by your local authorities.

### PRODUCT DIMENSIONS

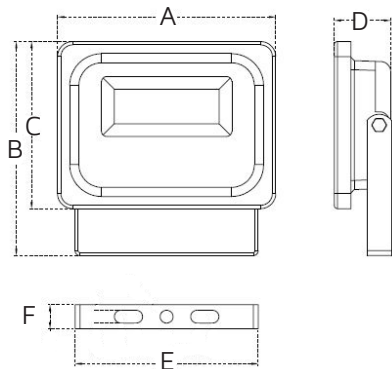

	A	B	C	D	E	F
10W	143	140.9	110	37	120	16
30W	186.5	169.8	144	37	166	20
50W	220	198.3	173	43	187	19
80W	270	244.3	220	46	237	23.5
100W	320	292.3	240	46	290	30

All units are in mm

### Important Warranty Information

The LED Slimline Flood Light has a 3 year warranty. To claim, you must provide the product part number and date of manufacture, which can be found on the label attached to the luminaire housing along with the original purchase invoice.

Manufactured in China by  
Leyond Lighting Co. Ltd.  
NET-15-04-XX

This luminaire contains built-in LED lamps.

LED

The lamps cannot be changed in the luminaire.

874/2012



NET LED Ltd.  
Bucknigh Business Park  
300 Anderson Road  
Cambridge  
CB24 4UQ  
sales@netled.co.uk  
www.netled.co.uk

Technical Helpline: 01223 851505  
Email: support@netled.co.uk

Drawing No: NET-15-04-SL-IG\_V2  
www.netled.co.uk/downloads



Distributed by



## LED SLIMLINE FLOOD LIGHT INSTALLATION GUIDE

### SLIMLINE FLOOD LIGHT NET-15-04-XX

### KEY DATA

Light Source	LED				
Power	10W	30W	50W	80W	100W
Luminous Flux	990lm	3350lm	5590lm	8640lm	10860lm
Luminous Efficacy	>100lm/W				
Colour Temperature	6000K				
Colour Rendering	>75 CRI				
Housing Material	Aluminium				
Diffuser Material	Glass				
IP Rating	IP66				
Manufacturer	Leyond				

### SUPPLY/EARTH CLASS

100-240V AC 50/60 Hz



Fig.1 Mains Input Termination

Class I

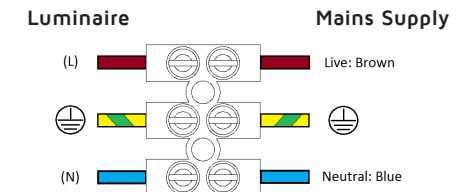

**Installation procedure:** Carefully read the installation instructions and ensure the mains supply is isolated before installation. Please read the safety information overleaf before carrying out any installation. Please retain this leaflet for future reference.

**Flood Light Installation:**

**Step 1:** Carefully remove the Slimline Flood Light from the packaging. Loosen the bolts on each side of the Slimline Flood Light and remove the mounting bracket.

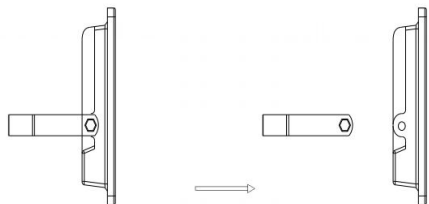

**Step 2:** Select a suitable mounting position and refer to the table below for the minimum recommended mounting height. Drill into the mounting surface and screw the bracket onto the mounting surface using suitable wall plugs and screws.

Power	Minimum Mounting Height
10W	2m
30W	2m
50W	2m
80W	2.5m
100W	3m

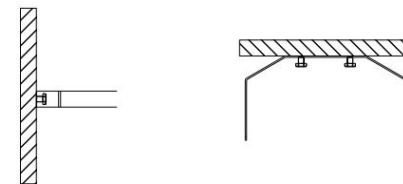

**Step 3:** Re-attach the Slimline Flood Light to the bracket.

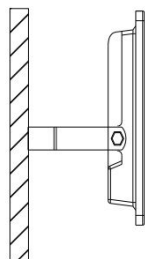

**Step 4:** Tilt the Slimline Flood Light to adjust it as required and tighten the bolts to lock the Slimline Flood Light in position.

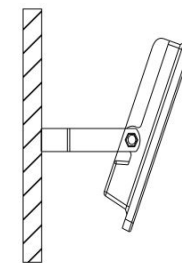

**Step 5:** Secure the supply cable to the wall using suitable clips. Ensure that the cable is not touching the body of the Slimline Flood Light.

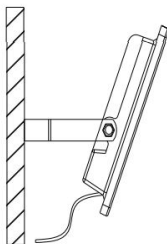

**Step 6:** Connect the cable to the mains as per the illustration below and test the LED Slimline Flood Light for correct operation.

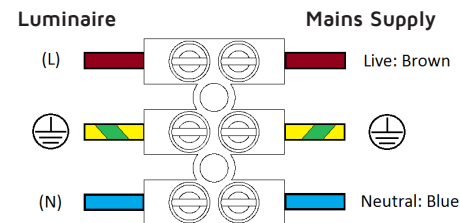

**Accessories**

**Motion and Photocell Sensor**

Available with a motion and photocell sensor. Ensures that the unit is switched off during daylight hours and only activated when motion is present.



**Accessories**

**Bracket**

Available with adjustable bracket featuring left to right orientation.

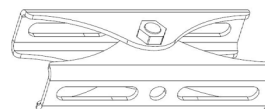

**Full product range available**

Visit [www.netled.co.uk](http://www.netled.co.uk) for more commercial LED lighting products, including:

Panel Lights, Downlights, T5 and T8 Tubes, Batten and Linear Luminaires, 2D Bulkheads and retrofit Gear Trays, Non-Corrosive Luminaires, High Bays and much more.