

### Safety Information

> All electrical work must be undertaken by a qualified contractor to ensure compliance with latest edition BS 7671 and IEE/IET wiring regulations.

> Before installing an LED Street Light or doing any maintenance, ensure power supply is turned off at the circuit breaker or fuse box.

> This product is designed for permanent connection to fixed wiring; the circuit should be protected with the appropriate MCB or fuse.

### Environment

> Please DO NOT dispose of electrical items or packaging as unsorted waste. Use the recycling facilities provided by your local authorities.

## PRODUCT DIMENSIONS

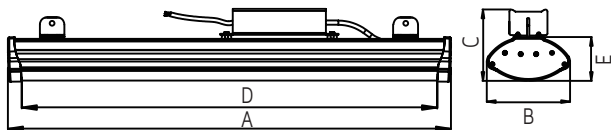

	A	B	C	D	E
150W	905	135	115	865	72

All units are in mm

### Important Warranty Information

The LED Linear High Bay has a 3 year warranty, which can be extended free of charge to 5 years by registering online via the website address below. The registrant must provide the product part number and date of manufacture, which can be found on the label attached to the luminaire housing.

Manufactured in China by  
FYT LED Co. Ltd.  
NET-23-12-XX



This luminaire contains built-in LED lamps.

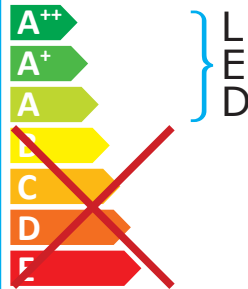

The lamps cannot be changed in the luminaire.

874/2012



FS 590684 EMS 590685

NET LED Ltd.  
Buckingway Business Park  
300 Anderson Road  
Cambridge  
CB24 4UQ  
sales@netled.co.uk  
www.netled.co.uk

Technical Helpline: 01223 851505  
Email: support@netled.co.uk

Drawing No: NET-23-12-SL-IG\_V1  
www.netled.co.uk/downloads



theLIA  
MEMBER

Distributed by

**NET LED**  
LIGHTING

**LED LINEAR HIGH  
BAY INSTALLATION  
GUIDE**

## LED LINEAR HIGH BAY NET-23-12-XX

### KEY DATA

Light Source	LED
Power	150W
Luminous Flux	20000lm
Luminous Efficacy	133lm/W
IP Rating	IP65
IK Rating	IK10
Colour Temperature	5000K
Colour Rendering	>80 CRI
Housing Material	Aluminium
Diffuser Material	Polycarbonate
Manufacturer	FYTLED

### SUPPLY/EARTH CLASS

100-270V AC 50/60 Hz  
Mains Input Termination



Class I

### Mains Input Termination

Luminaire

Mains Supply

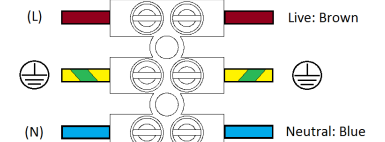

### 1-10V Dimming Terminal

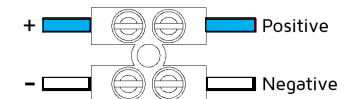

**Installation procedure:** Carefully read the installation instructions and ensure the mains supply is isolated before installation. Please read the safety information overleaf before carrying out any installation. Please retain this leaflet for future reference.

**Installation instructions for suspended use:**

**Step 1:** Drill two 10mm holes where the Linear High Bay is going to be installed.

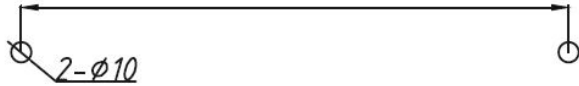

**Step 2:** Fix the expansions screws in the holes.

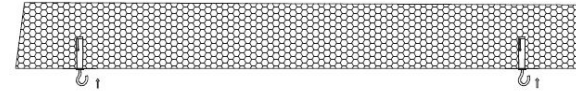

**Step 3:** Connect the Linear High Bay to the suspension kit; make sure the safety clip is closed.

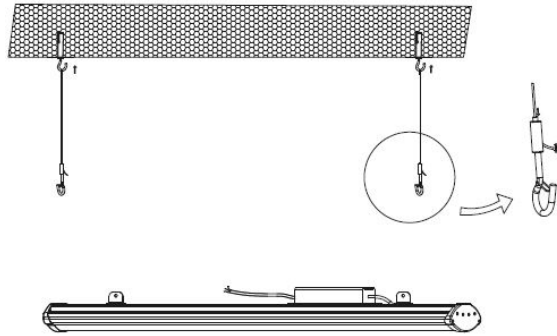

**Step 4:** Connect the driver to the power line according to the wiring diagram below.

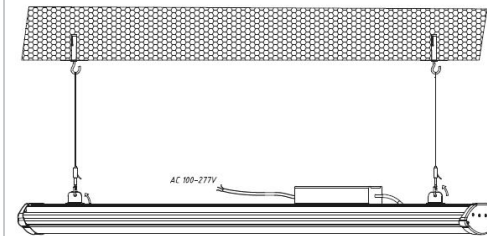

**Mains Input Termination**

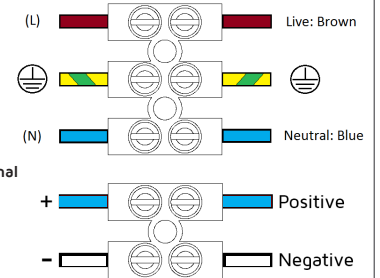

**LED High Bays**

Available in 100W, 150W & 200W, the Orwell Range of LED High Bays are dimmable (1-10V) as standard.



**LED High Power Flood Lights**

Available in 150W, 200W & 240W.



**Full product range available**

Visit [www.netled.co.uk](http://www.netled.co.uk) for more commercial LED lighting products, including:

Panel Lights, Downlights, T5 and T8 Tubes, Batten and Linear Luminaires, 2D Bulkheads and retrofit Gear Trays, Non-Corrosive Luminaires and much more.